

ADVANCED EXHAUST SOLUTIONS

Application

AES rectangular silencers offer broad range acoustic performance in a compact, thermally insulated package. AES MTU engine specific rectangular silencers are designed to the unique exhaust and performance requirements of your MTU application.

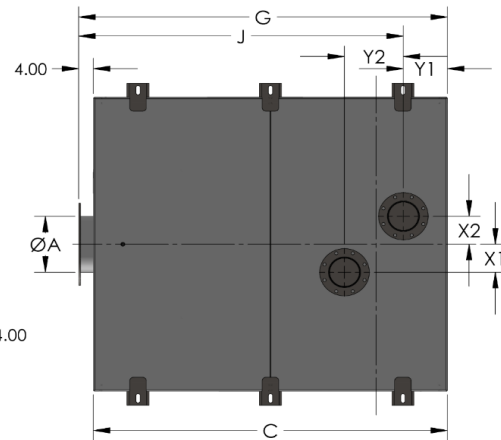
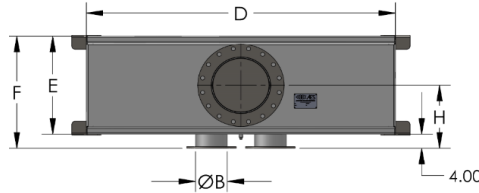

Part Number	Engine	Inlet Configuration	Inlet Size (B)	Outlet Size (A)	Length (C)	Width (D)	Thickness (E)	F	G	H	J	X1	X2	Y1	Y2	Weight	DXF	STEP
000-008-543	6R1600	Single	6	8	84	42	24	28	88.5	16	76.50	---	13	12	---	1667	DXF	STEP
000-008-544	8V1600	Dual	5	10	84	42	24	28	88.5	16	68.50	30.25	30.25	20.00	0.00	1716	DXF	STEP
000-008-545	10V1600	Dual	5	10	96	60	28	32	100.5	18	88.50	21.25*	21.25*	12.00	0.00	2476	DXF	STEP
000-008-546	12V1600	Dual	5	12	96	60	28	32	100.5	18	88.50	21.25*	21.25*	12.00	0.00	2493	DXF	STEP
000-008-547	12V2000	Dual	6	14	132	72	30	34	136.5	19	124.50	24.88	24.88	29.38	-17.38	3682	DXF	STEP
000-008-548	16V2000	Dual	6	16	132	78	32	36	136.5	20	124.50	24.84	24.84	12.00	17.42	4034	DXF	STEP
000-008-549	18V2000	Dual	8	16	132	78	32	36	136.5	20	124.50	12.60	12.60	12.00	1.36	4087	DXF	STEP
000-008-550	12V4000	Dual	10	20	144	96	38	42	148.5	23	136.50	0.00	0.00	12.00	19.00	5566	DXF	STEP
000-008-551	16V4000	Dual	10	26	144	96	40	44	148.5	24	160.50	0.00	0.00	-12.00	37.00	5860	DXF	STEP
000-008-552	20V4000	Triple	10	28	144	96	44	48	148.5	26	*	*	*	*	*	6101	DXF	STEP

* 20V4000 triple inlet design matches engine outlet spread of 27.75 along crankshaft CL

All dimensions are in inches, all weights are in pounds and are approximate.

Overall insertion loss is approximate, and is system dependent.

The information provided in this document is intended for informational purposes only and is subject to change without notice.

Silencer Design

- Carbon Steel Service Temp Limits
900° F Continuous
1000° F Intermittent
- 125/150# ANSI Flange Bolt Pattern
- Thermal/Acoustically Insulated
- 0.50" NPT Drain
- High Temp Black Paint (rated to 1200° F)
- Standard Top and Bottom Mounting Lugs
- Continuously Welded Construction

Silencer Options

- 304SS, 316SS and 321SS construction
- Aluminum Thermal Spray Coat Finish
- High Performance Ceramic Coating
- Dual Inlet and Outlet Configurations
- Custom Mounting /Structural Upfitting
- Flush Inlet Flange with Weld Nuts
- Custom Integral Emissions Modules
- Spark Arresting Capable

Class 8 Rectangular Transmission Loss Curve

