



ADVANCED EXHAUST SOLUTIONS

Disk Silencer

Class 5

Cummins Hospital Grade

30-35 dB Overall Insertion Loss

Application

AES disk silencers offer broad range acoustic performance in a compact, thermally insulated package. AES Cummins engine specific disk silencers are designed to the unique exhaust and performance requirements of your Cummins application.

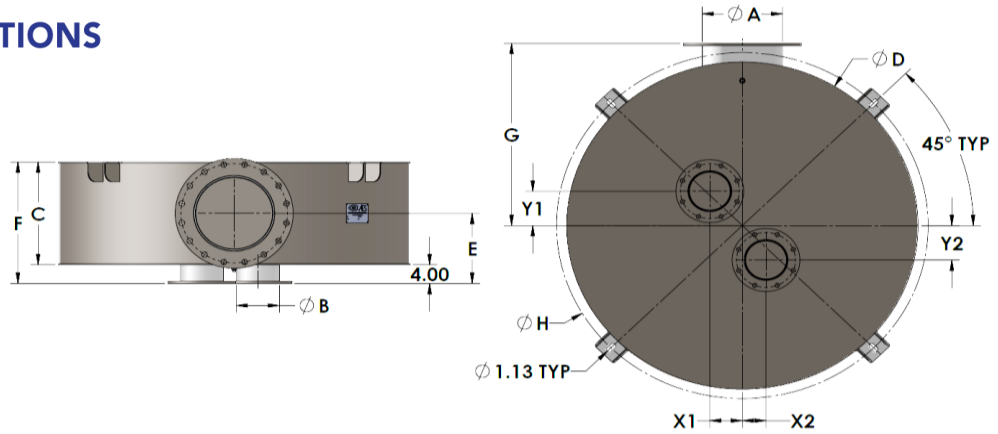

Part Number <small>Click For PDF</small>	Engine	Inlet Configuration	Inlet Size (B)	Outlet Size (A)	Thickness (C)	Diameter (D)	E	F	G	H	X1	X2	Y1	Y2	Weight	DXF	STEP
000-001-326	4BT3.3	Single	4	4	12	32	10	16	20	36	-6.00*	-	0	-	315	DXF	STEP
000-001-385	QSB5	Single	4	4	12	32	10	16	20	---	-7.5	-	0	-	310	DXF	STEP
000-001-240	QSB7	Single	5	5	14	38	11	18	23	42	7.19	-	0	-	425	DXF	STEP
000-001-241	QSL9	Single	6	6	16	46	12	20	27	50	-10.00	-	0	-	600	DXF	STEP
000-001-242	QSM11	Single	6	6	16	46	12	20	27	50	-10.00*	-	0	-	600	DXF	STEP
000-001-243	QSX15	Single	8	8	18	54	13	22	31	58	-16	-	0	-	810	DXF	STEP
000-001-244	QSK19	Single	10	10	20	62	14	24	35	66	-14.41	-	0	-	1065	DXF	STEP
000-001-245	QSK23	Single	10	10	20	62	14	24	35	66	-13.00	-	0	-	1065	DXF	STEP
000-001-246	QST30	Dual	6	12	22	70	15	26	39	74	6.65	6.65	2.09	2.09	1320	DXF	STEP
000-001-247	QSK50	Dual	8	16	26	82	17	30	45	86	5.59	5.59	7.36	7.36	1850	DXF	STEP
000-001-248	QSK60	Dual	10	18	28	88	18	32	48	92	27.00	27.00	7.00	7.00	2130	DXF	STEP
000-001-249	QSK78	Dual	12	20	30	94	19	34	51	98	-2.36	-2.36	13.27	13.27	2450	DXF	STEP
000-001-250	QSK95	Dual	14	22	32	96	20	36	52	100	10.50	10.50	2.85	2.85	2675	DXF	STEP

The information provided in this document is intended for informational purposes only and is subject to change without notice.

All dimensions are in inches, all weights are in pounds and are approximate.

Transmission loss curve is based on standard silencer design and is representative of approximate performance.

Overall Insertion loss is approximate, and system dependent.

* Inlet offset does not match crankshaft CL to turbo offset.

Silencer Design

- Carbon Steel Service Temp Limits
 - 900° F Continuous
 - 1000° F Intermittent
- 125/150# ANSI Flange Bolt Pattern
- Thermal/Acoustically Insulated
- 0.50" NPT Drain
- High Temp Black Paint (rated to 1200° F)
- Top Mounted Integral Mounting Lugs
- Continuously Welded Construction

Silencer Options

- 304SS, 316SS and 321SS construction
- Aluminum Thermal Spray Coat Finish
- High Performance Ceramic Coating
- Dual Inlet and Outlet Configurations
- Custom Mounting /Structural Upfitting
- Flush Inlet Flange with Weld Nuts
- Custom Integral Emissions Modules
- Spark Arresting Capable

Class 5 Disk Transmission Loss Curve

