

ADVANCED EXHAUST SOLUTIONS

Application

AES disk silencers offer broad range acoustic performance in a compact, thermally insulated package. AES Caterpillar engine specific disk silencers are designed to the unique exhaust and performance requirements of your Caterpillar application.

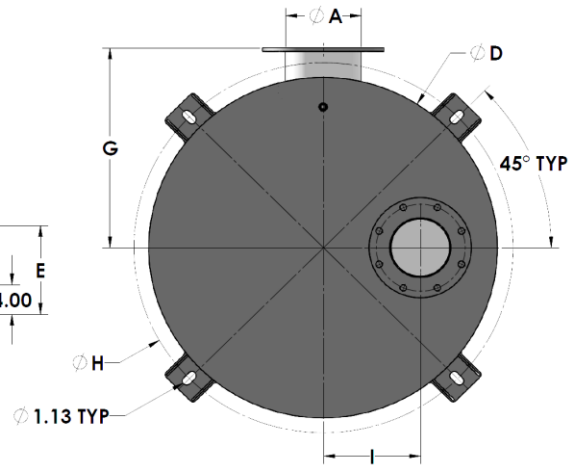
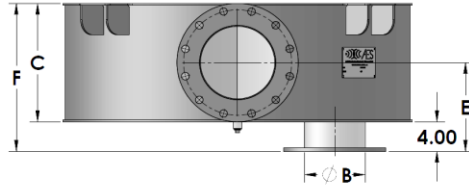

Part Number Click For PDF	Engine	Inlet Configuration	Inlet Size (B)	Outlet Size (A)	Thickness (C)	Diameter (D)	E	F	G	H	Spread / Offset I	Weight	DXF	STEP
000-011-205	C4.4	Single	4	4	12	32	10	16	20	-	7.50	315	DXF	STEP
000-001-010	C9	Single	6	6	16	46	12	20	27	50	12.06	606	DXF	STEP
000-001-011	C15	Single	8	10	18	54	13	22	31	58	12.81	859	DXF	STEP
000-001-012	C18	Single	8	10	18	54	13	22	31	58	14.41	859	DXF	STEP
000-001-013	C27	Single	10	10	20	62	14	24	35	66	0	1084	DXF	STEP
000-001-014	C32	Single	10	12	20	62	14	24	35	66	0	1101	DXF	STEP
000-001-015	3512C	Dual	8	16	26	82	17	30	45	86	20.45	1906	DXF	STEP
000-001-016	3516C	Dual	10	18	28	88	18	32	48	92	20.45	2162	DXF	STEP
000-001-017	3516C-HD	Dual	12	20	30	94	19	34	51	98	20.45	2490	DXF	STEP
000-001-018	C175-16	Quad	10	22	30	94	19	34	51	98	SEE PDF	2603	DXF	STEP
000-001-019	C175-20	Dual	18	24	32	96	20	36	52	100	38.5	2868	DXF	STEP

The information provided in this document is intended for informational purposes only and is subject to change without notice.

All dimensions are in inches, all weights are in pounds and are approximate.

Transmission loss curve is based on standard silencer design and is representative of approximate performance.

Overall Insertion loss is approximate, and system dependent.

Silencer Design

- Carbon Steel Service Temp Limits
900° F Continuous
1000° F Intermittent
- 125/150# ANSI Flange Bolt Pattern
- Thermal/Acoustically Insulated
- 0.50" NPT Drain
- High Temp Black Paint (rated to 1200° F)
- Top Mounted Integral Mounting Lugs
- Continuously Welded Construction

Silencer Options

- 304SS, 316SS and 321SS construction
- Aluminum Thermal Spray Coat Finish
- High Performance Ceramic Coating
- Dual Inlet and Outlet Configurations
- Custom Mounting /Structural Upfitting
- Flush Inlet Flange with Weld Nuts
- Custom Integral Emissions Modules
- Spark Arresting Capable

Class 5 Disk Transmission Loss Curve

