



# ADVANCED EXHAUST SOLUTIONS

Disk Silencer

Class 4

Caterpillar Critical Grade

25-30 dB Overall Insertion Loss

## Application

AES disk silencers offer broad range acoustic performance in a compact, thermally insulated package. AES Caterpillar engine specific disk silencers are designed to the unique exhaust and performance requirements of your Caterpillar application.

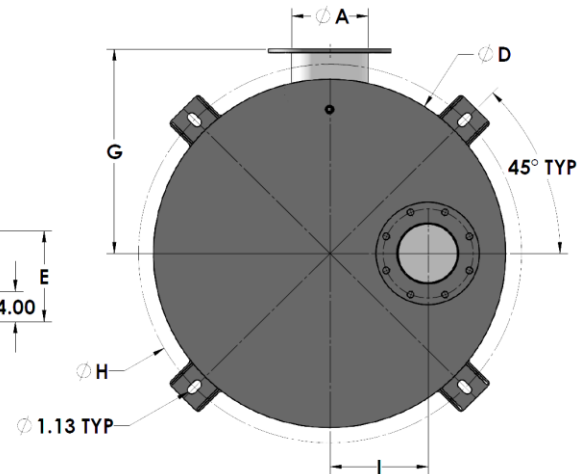
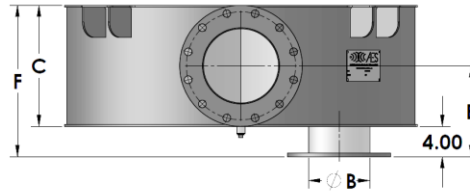

Part Number <a href="#">Click For PDF</a>	Engine	Inlet Configuration	Inlet Size (B)	Outlet Size (A)	Thickness (C)	Diameter (D)	E	F	G	H	Spread / Offset	Weight	DXF	STEP
000-007-288	C4.4	Single	4	4	10	26	9	14	17	30	5.00	227	DXF	STEP
000-012-484	C7.1	Single	5	5	12	32	10	16	20	36	10.17	318	DXF	STEP
000-001-000	C9	Single	6	6	14	38	11	18	23	42	12.06	434	DXF	STEP
000-001-001	C15	Single	8	8	14	46	11	18	27	50	12.81	592	DXF	STEP
000-001-002	C18	Single	8	8	14	46	11	18	27	50	14.41	590	DXF	STEP
000-001-003	C27	Single	10	10	18	54	13	22	31	58	0	827	DXF	STEP
000-001-004	C32	Single	10	12	18	54	13	22	31	58	0	839	DXF	STEP
000-001-005	3512C	Dual	8	14	20	62	14	24	35	66	20.45	1098	DXF	STEP
000-001-006	3516C	Dual	10	16	22	70	15	26	39	74	20.45	1379	DXF	STEP
000-001-007	3516C-HD	Dual	12	18	24	76	16	28	42	80	20.45	1607	DXF	STEP
000-001-008	C175-16	Quad	10	20	26	82	17	30	45	86	SEE PDF	1890	DXF	STEP
000-001-009	C175-20	Dual	18	22	28	88	18	32	48	92	38.50	2215	DXF	STEP

The information provided in this document is intended for informational purposes only and is subject to change without notice.

All dimensions are in inches, all weights are in pounds and are approximate.

Transmission loss curve is based on standard silencer design and is representative of approximate performance.

Overall Insertion loss is approximate, and system dependent.

## Class 4 Disk Transmission Loss Curve

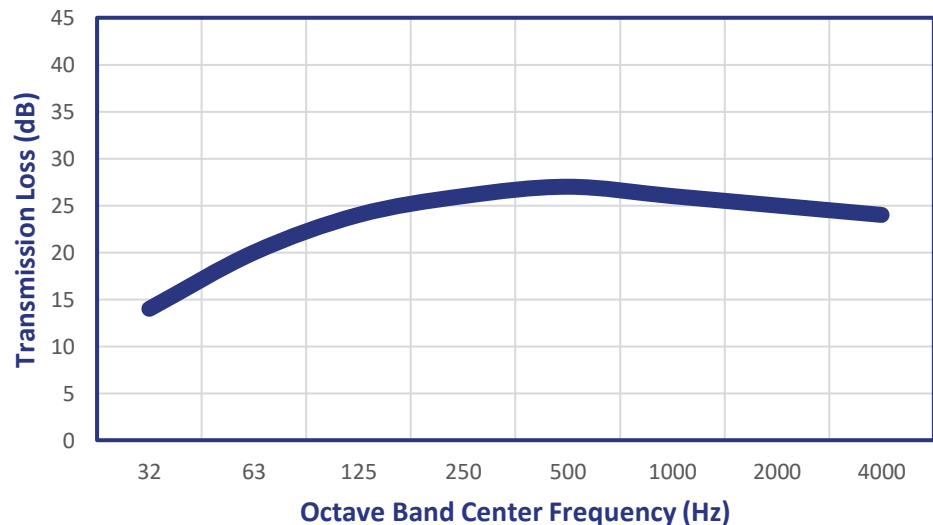

## Silencer Design

- Carbon Steel Service Temp Limits  
900° F Continuous  
1000° F Intermittent
- 125/150# ANSI Flange Bolt Pattern
- Thermal/Acoustically Insulated
- 0.50" NPT Drain
- High Temp Black Paint (rated to 1200° F)
- Top Mounted Integral Mounting Lugs
- Continuously Welded Construction

## Silencer Options

- 304SS, 316SS and 321SS construction
- Aluminum Thermal Spray Coat Finish
- High Performance Ceramic Coating
- Dual Inlet and Outlet Configurations
- Custom Mounting /Structural Upfitting
- Flush Inlet Flange with Weld Nuts
- Custom Integral Emissions Modules
- Spark Arresting Capable